

Locking functions of mortise-, and panic mortise locks

■ Panic lock with locking function **E** (Latch lever function)

The dead bolt and the latch bolt are switched back by key from the outside. The door is **open** now. But the door can be opened any time **by the handle** (from the inside), even **when the dead bolt is locked**. After a **panic release** and shutting the door, the door is **still not accessible by the outer handle**. Admittedly the door is only locked by the latch bolt, because the dead bolt stays inside the lock case until locking by key.

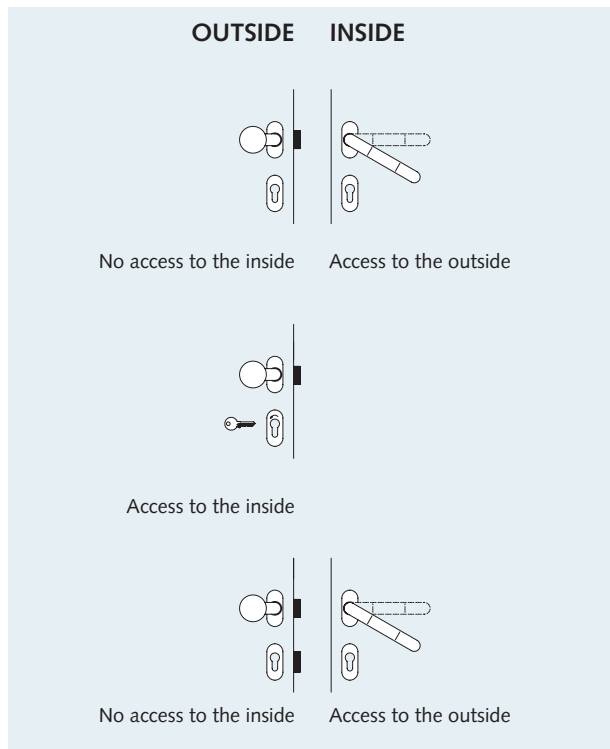

■ Usage reference

For doors where an unauthorized access from the outside must always be prevented.

The door cannot accidentally be unlocked, because after shutting the door, the opening from the outside is only possible by key.

■ Panic lock with locking function **B** (Switching function with dead bolt)

To **open** the door **from the outside**, the outer handle must be enabled by **key** (key must be turned in **opening-direction to the end position**). Now the door is accessible from the inside and the outside. If the key is turned to closing direction until the dead bolt is locked and then taken out of the cylinder, the **outer handle switches automatically into idling mode**. But the **door can be opened any time by inner handle, even without a key**. After **panic release** from the inside and shutting the door, the door is still **not accessible from the outside** (locked).

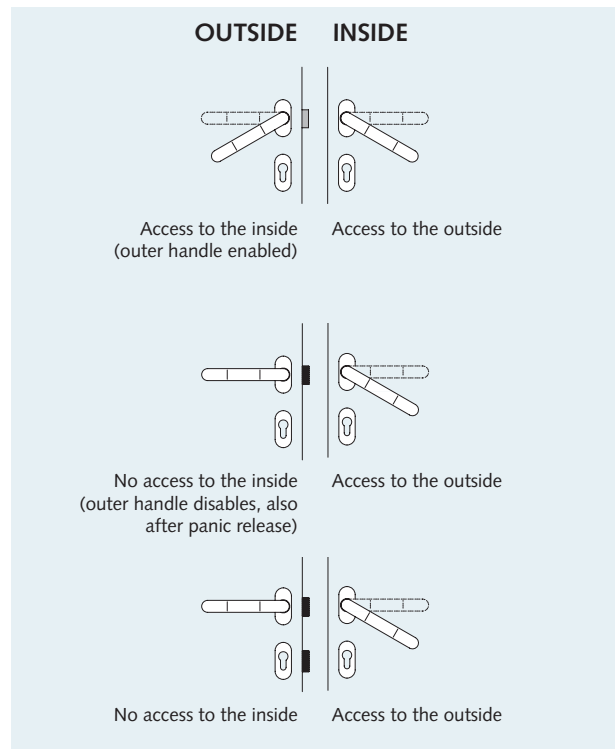

■ Usage reference

For doors which must allow a temporary access from the inside and the outside.

After a panic release from the inside, the outer handle is still in idling mode.

Instructions for safed latch arrester

- Panic lock with locking function (Passage function)



To open the door from the outside, the dead bolt can be switched back by the key and the latch can be switched back by the outer handle. The door is now **accessible from the inside and the outside**. If the dead bolt is locked by key the door is not accessible from the outside anymore, because the door is held by the dead bolt. But the door is accessible **any time from the inside by handle**, even **without a key**. After panic release (from the inside) and **shutting the door**, the door is accessible from the outside (open).

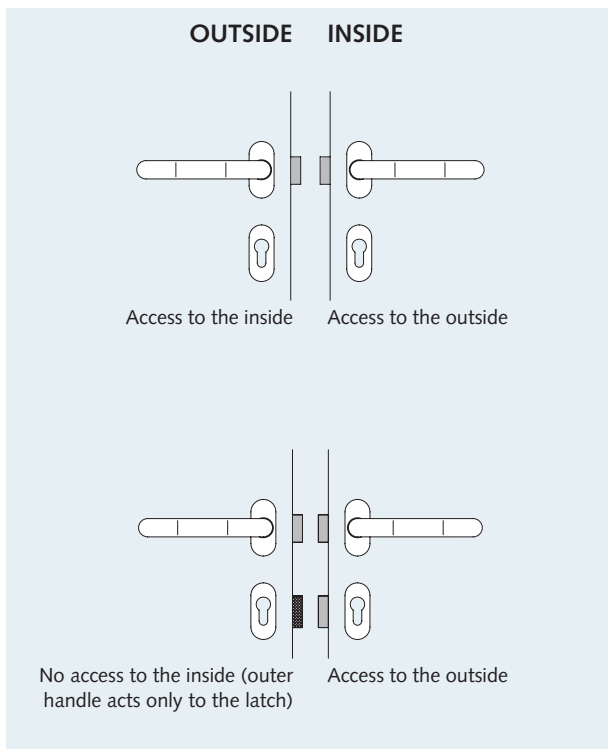

- Usage reference

For doors, which must allow a temporary access from the inside and the outside.
After a panic release from the inside the door is accessible from the outside, e.g. to allow an easy access for rescue staff.

- Instructions for safed latch arrester

Activation of safed latch arrester:

1. The latch must be pushed in into end position by hand (not by the handle). Keep in that position until step 3 is done.
 2. Turn the key in opening direction to end position.
 3. Pull the key out of the cylinder.
- The latch is arrested!

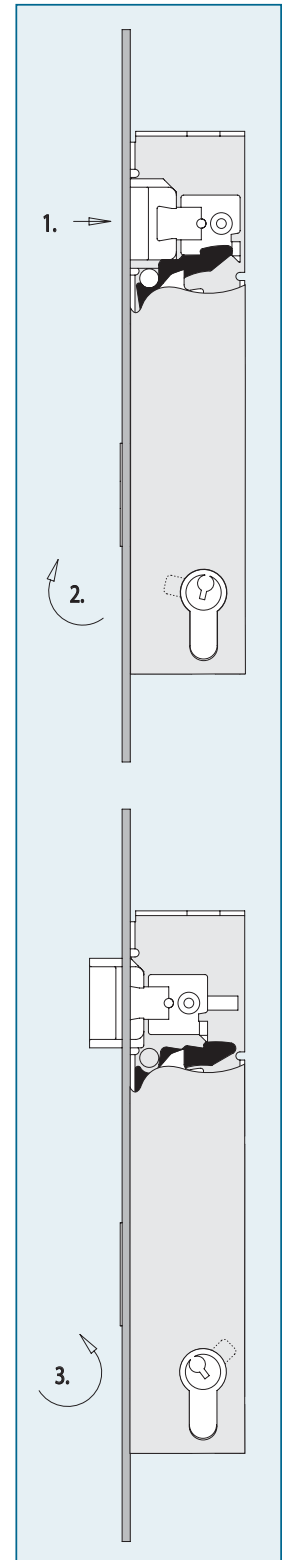

Deactivation of safed latch arrester:

1. The latch must be pushed in into end position by hand (not by the handle). Keep in that position until step 2 is done.
 2. Lock the dead bolt by key.
- The latch is free!